

Home...  
As beautiful as your dream



**Akanksha**  
**ENCLAVE**  
SAPNO KA GHAR



# Township Map

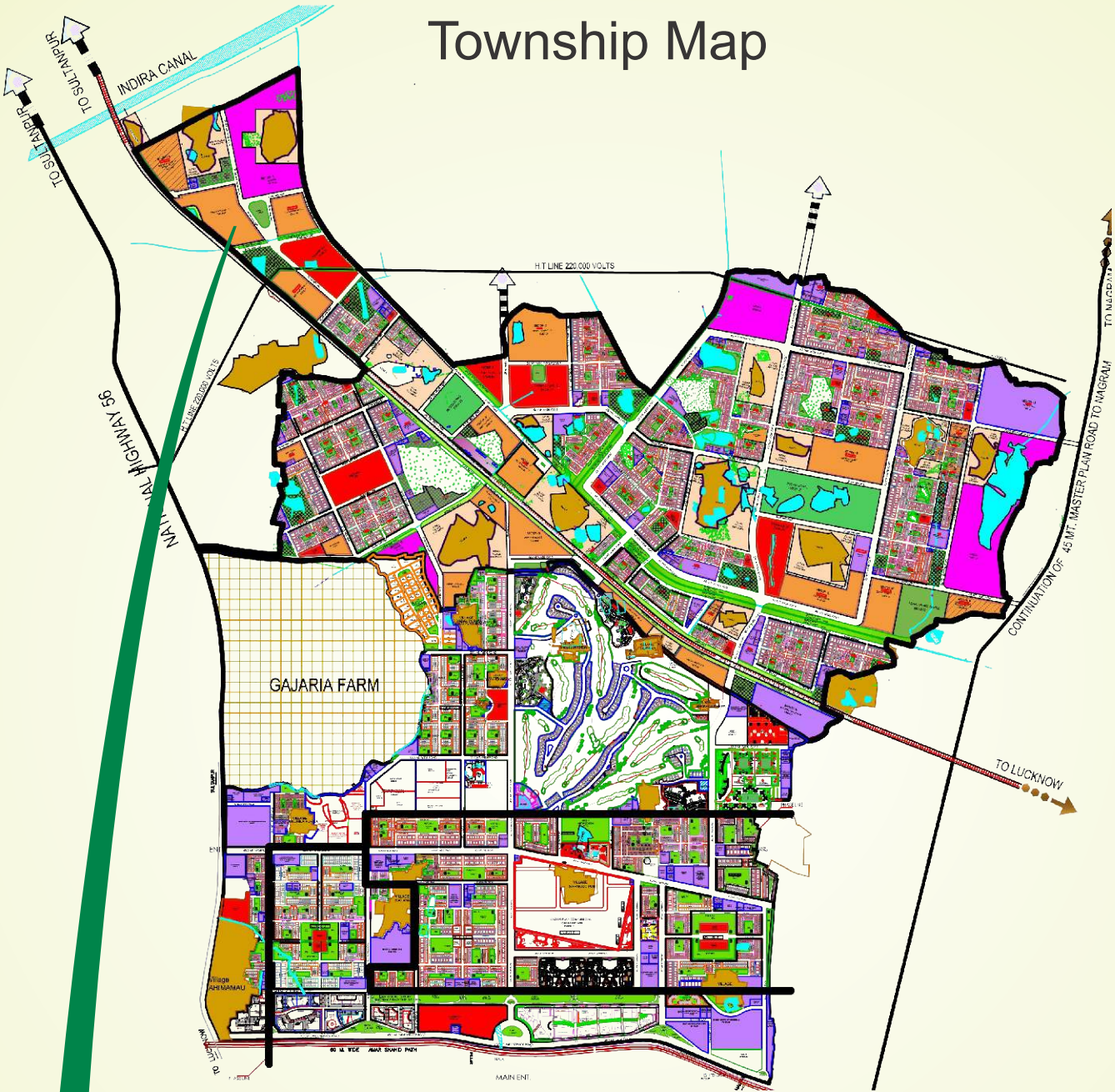

Map not to scale





# S I T E P L A N



## Advantage – Akanksha Enclave

- Akanksha Enclave group housing offers comfortable and spacious 2 BHK and 3 BHK apartments
- Earthquake resistant structure
- 24x7 securitised enclave
- Easy accessibility
- Low pollution level with natural environs
- Apartment with optimum space management
- Well spread out walkways
- Shopping area in close proximity



# S+16 (TYPE A)

## BLOCK 1- (S+16)

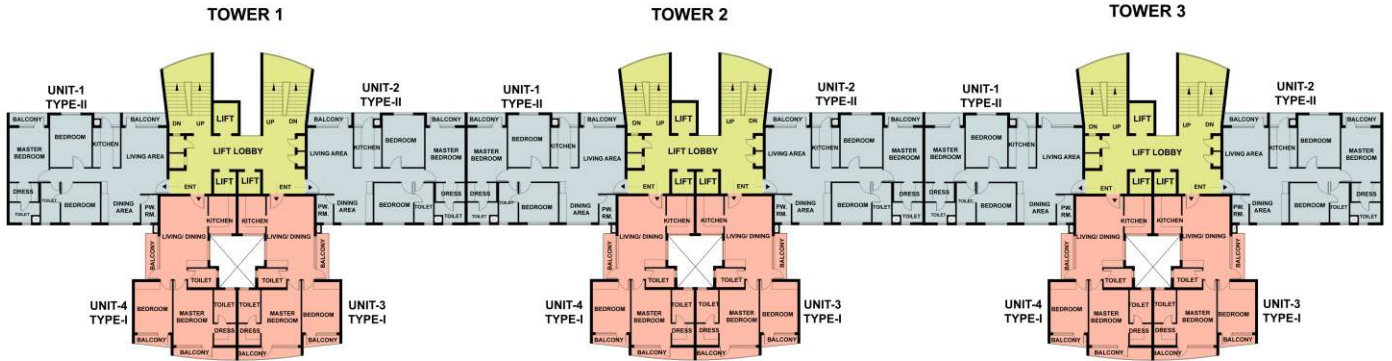

**TYPICAL FLOOR PLAN (IST TO 16TH FLOOR)**

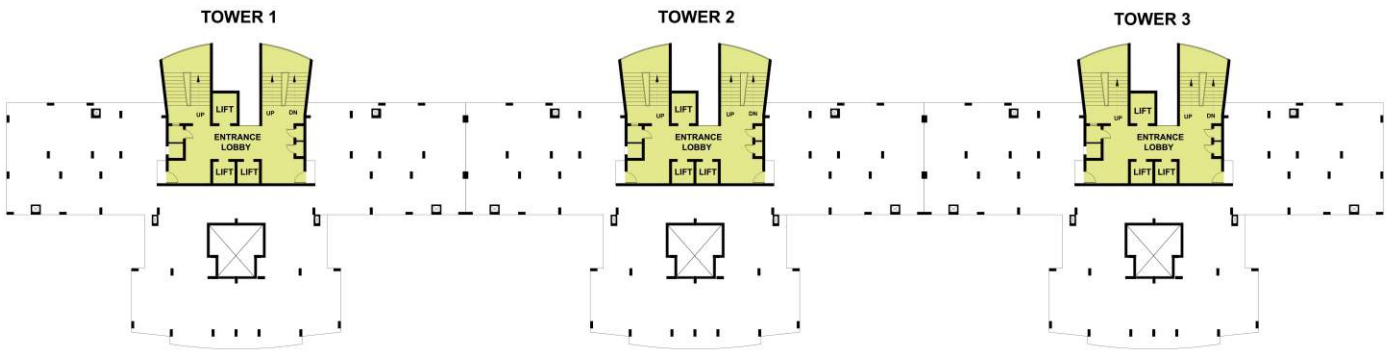

**STILT FLOOR PLAN**

**TYPE A -BLOCK**

- TYPE I - 2 BHK
- TYPE II - 3 BHK
- ENTRANCE / LIFT LOBBY

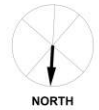

## SPECIFICATIONS

STRUCTURE	Framed structure conforming to BIS seismic codes with masonry filler walls	
FLOOR FINISHES	Living/Dining Bedrooms Stairs Balconies	Vitrified tiles Ceramic tiles Stone flooring on treads Non-skid ceramic tiles
TOILETS	Flooring Walls Chinaware Counter Water Supply Other Fixtures	Non-skid ceramic tiles/porcelain tiles Tiles as per architectural design European type WC, hand wash basin, CP fittings Stone counter (wherever shown in Sale Plan) Provision for hot and cold water supply Soap dish and health faucet
KITCHEN	Flooring Dado Counter Water Supply Fittings Sink	Non-skid ceramic tiles or equivalent Ceramic tile cladding on walls as per architectural design Marble Provision for hot and cold water supply CP fittings Stainless steel sink with drain board
JOINERY	Windows Doors	UPVC/Anodized aluminum with float glass Machine made moulded door shutter with aluminum fittings
FINISHES	Internal Exterior	Drawing/Dining rooms, Bedroom walls shall be finished with O.B.D. paint Pleasing elevation with semi-permanent finish / all weather exterior paints
OTHER FEATURES	Electrical  Telecommunication	Copper wiring in conduits with modular switches.  Provision of telephone points in drawing/dining room and all bedrooms. Provision of TV aerial points in drawing room and all bedrooms

# UNIT PLAN TYPE - A

Area - 1524 sq.ft.



TYPE - A, 2 BHK - UNIT 3 & 4



Area - 1948 sq.ft.

TYPE - A, 3 BHK - UNIT 1 & 2



## Highlights of the Township



Ansal API Auto Park  
North India's first Auto Park launched



Best Price - Joint venture between  
Bharti & Wal-mart (Operational)



G.D. Goenka Public School  
Academy session started



Ansal Institute of Technology &  
Management (AITM)



Map not to scale

### Delhi Corporate Office:-

115, Ansal Bhawan, 16 Kasturba Gandhi Marg, New Delhi 110001, Tel: 011-23353550, 23717854, 66302265/66/68/69, Fax:66302261,  
E-mail: info@ansalapi.com, Website: www.ansalapi.com, www.sushantgolfcity.in

### Lucknow City Office :-

1st Floor, YMCA Campus, 13 Rana Pratap Marg, Lucknow- 226001., Ph: 0522 - 4096200

**Toll Free No.:- 1800 266 5565 SMS 'API' to 57575**